

notes
 this drawing and design is the copyright of aja architects llp and must not be reproduced in part or in whole without prior written consent. contractors must verify all dimensions on site before commencing work or preparing shop drawings if in doubt ASK.
 Where this drawing contains any Ordnance Survey mapping material, it has been reproduced under license number 10052278.
 Ordnance Survey © Crown copyright

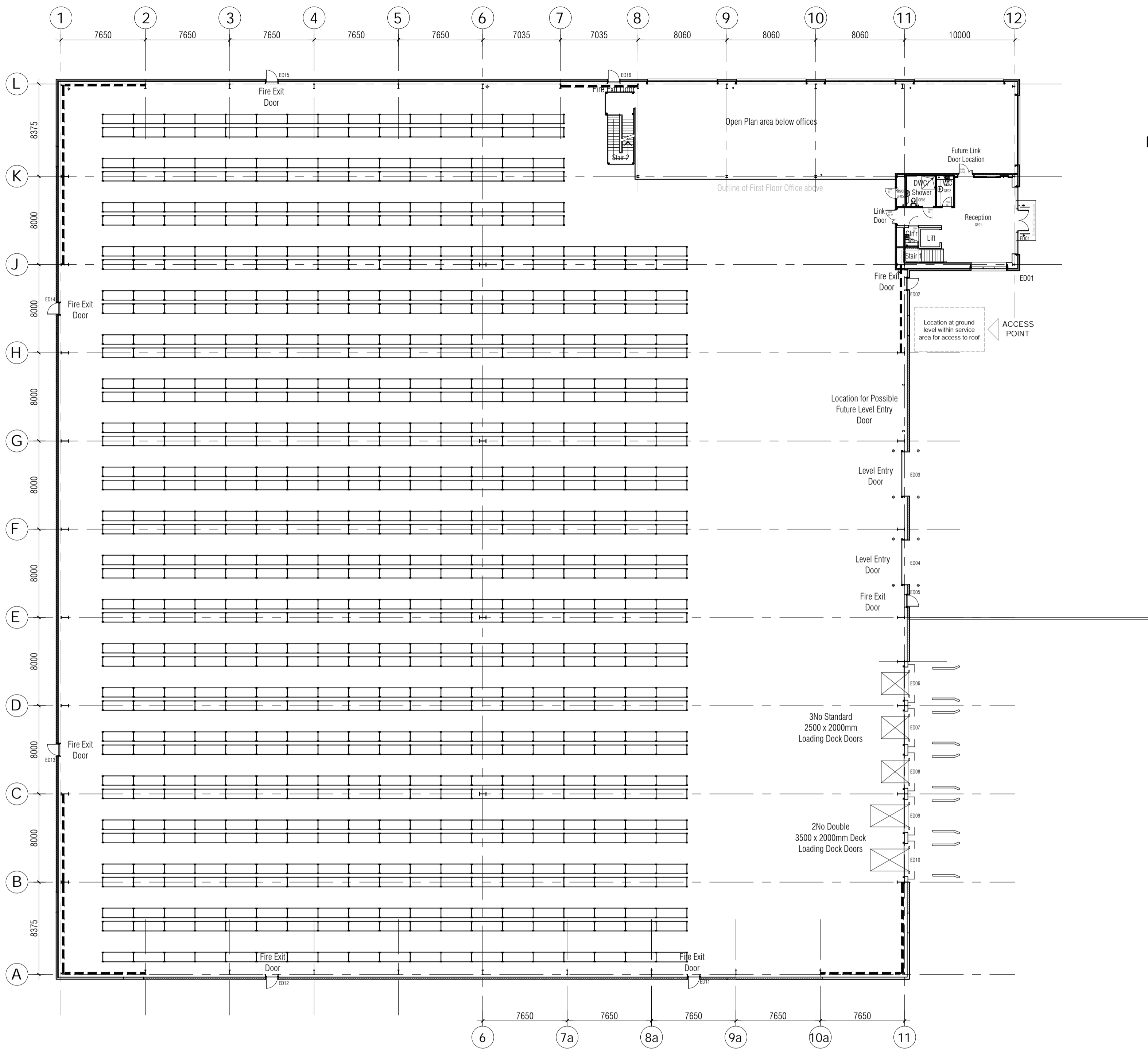

Narrow Aisle Racking Solution
 7,841 no. pallet positions
 based on 6 standard levels plus a seventh level between portal frames where height allows.

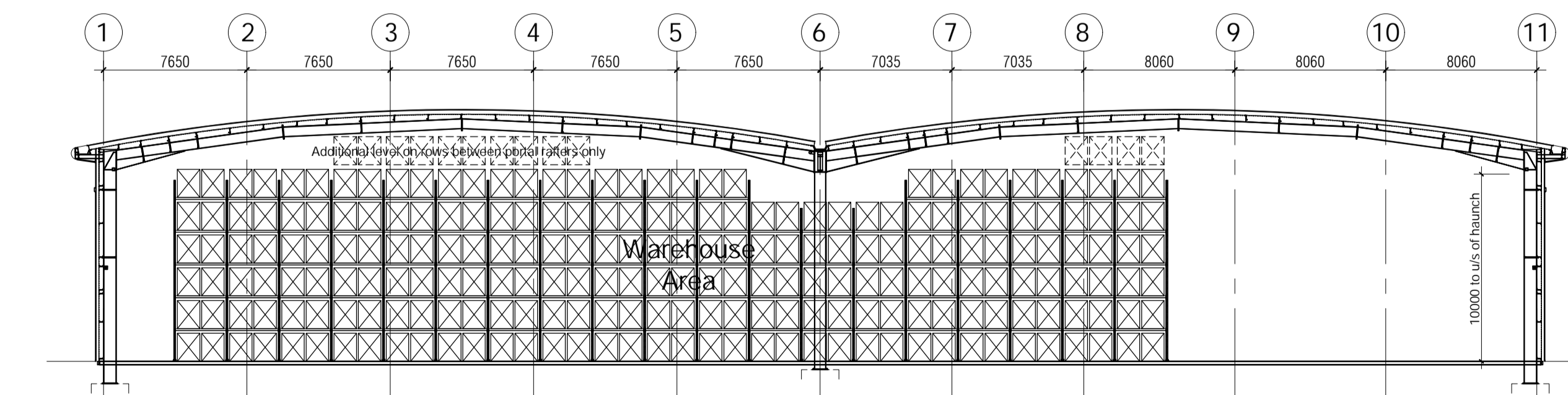

Cross Section

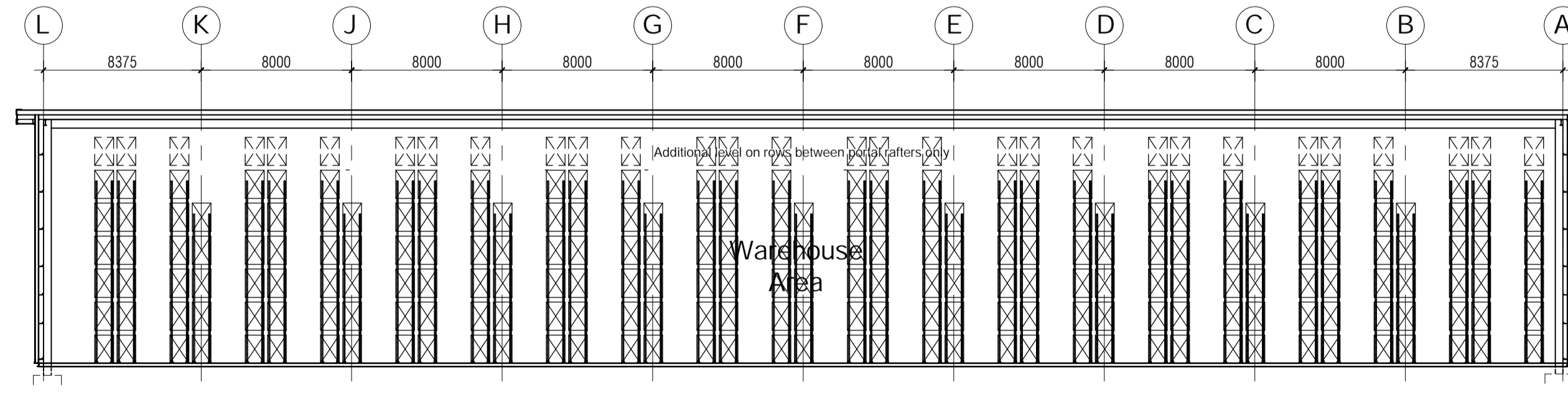

Long Section

no. date revision by



aja architects llp T: 024 7625 3200
 1170 Elliott Court F: 024 7625 3210
 Herald Avenue
 Coventry Business Park E: aja@aja-architects.com
 COVENTRY CV5 6UB W: www.aja-architects.com

AJA Architects is the trading style of AJA Architects Consulting Limited (a limited company no. 1649279) and AJA Architects LLP (a limited liability partnership registered in England no. OC336721).
 client

BARBERRY

project

Barberry 72
 Sopwith Way, Daventry

drawing

Warehouse
 Narrow Aisle Racking

scale 1:250 @ A1 drawn nn

checked mjl date 28.05.20

no

6423 - 071